

???

?????

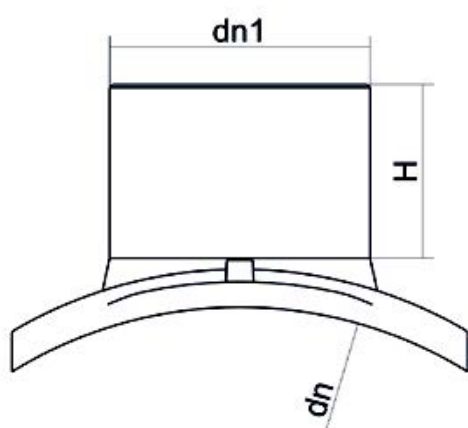

PRODUCT DETAILS	
ITEM CODE	CPSP315-450075C
dn	315/450 - 75
SDR DESIGN	11

GEOMETRIC CHARACTERISTICS	
dn	315/450
dn1	75
H [mm]	90
Mass [kg]	1.08

\*The pictures are for illustrative purposes only. the product may differ in color and / or some of its parts.

PLASTITALIA SPA reserves the right to revise this specification, while maintaining compliance with the requirements of the product without prior notice. Tolerance on diameters and thickness according to the standards unless otherwise specified. Tolerance:  $\pm 5\%$