

???

????

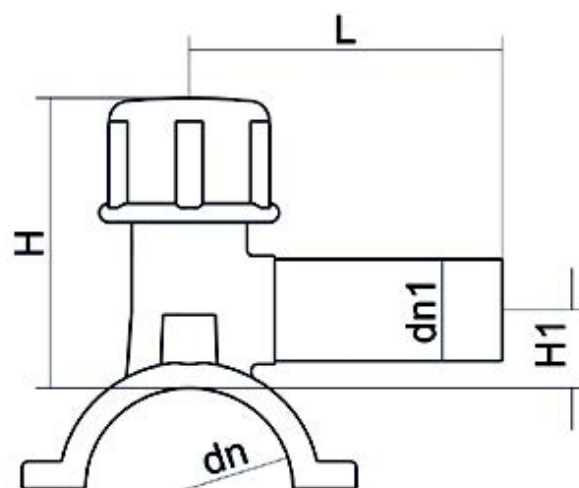

PRODUCT DETAILS		GEOMETRIC CHARACTERISTICS	
ITEM CODE	CPCP315040C	dn	315
dn	315 - 40	dn1	40
SDR DESIGN	11	H [mm]	165
		H1 [mm]	42
		L [mm]	105
		Mass [kg]	1.4

*The pictures are for illustrative purposes only. the product may differ in color and / or some of its parts.

PLASTITALIA SPA reserves the right to revise this specification, while maintaining compliance with the requirements of the product without prior notice. Tolerance on diameters and thickness according to the standards unless otherwise specified. Tolerance: $\pm 5\%$