

????

?????

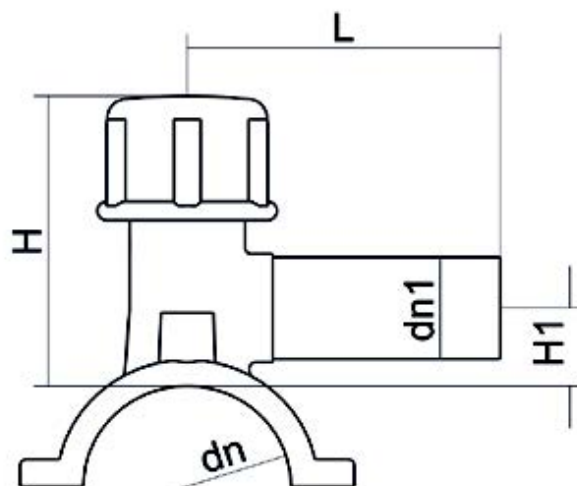

PRODUCT DETAILS		GEOMETRIC CHARACTERISTICS	
ITEM CODE	CPCP280025C	d_n	280
d_n	280 - 25	d_{n1}	25
SDR DESIGN	11	H [mm]	160
		H1 [mm]	40
		L [mm]	105
		Mass [kg]	1.36

*The pictures are for illustrative purposes only. the product may differ in color and / or some of its parts.

PLASTITALIA SPA reserves the right to revise this specification, while maintaining compliance with the requirements of the product without prior notice. Tolerance on diameters and thickness according to the standards unless otherwise specified. Tolerance: $\pm 5\%$